

# Rauch Mfg Inc.

Rauch Spinning tool  
Manuals and  
instructions

## Getting Started

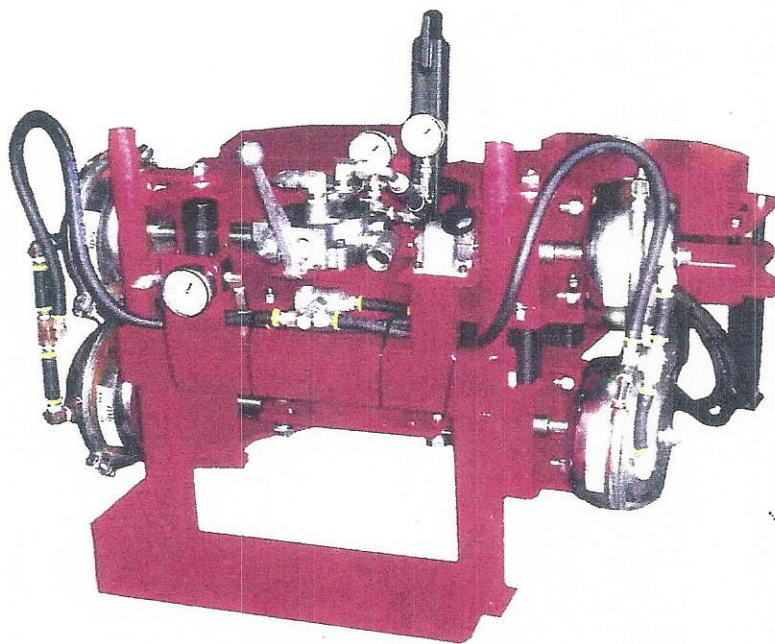

---

*Does the job easier,  
safer and faster,  
maximizing efficiency on  
all your jobs*

---

**Rauch Spinner**

**Model 517**

| <u>ITEM #</u> | <u>ORDER #</u>             | <u>QUANTITY</u> | <u>DESCRIPTION</u>                               |
|---------------|----------------------------|-----------------|--|
| 1             | 517-Bearing-RA104          | 8 each          | Bearing BCA NPS-104-RPC                          |
| 2             | 517-Flange T/B             | 16 each         | Bearing Flanges 72MM-3ZP                         |
| 3             | 517-3/8 x 5/8 bolt         | 24 each         | 3/8" x 5/8" bolt                                 |
| 4             | 517-3/8 lockwasher         | 24 each         | 3/8" lock washer                                 |
| 5             | 517-1/2 x 4 1/2 bolt       | 16 each         | 1/2" x 4 1/2" bolt                               |
| 6             | 517-1/2 pipe spacer        | 4 each          | 1/2" pipe spacers                                |
| 7             | 517-tubing spacer          | 10 each         | Tubing Spacers                                   |
| 8             | 517-1/2" locknut           | 20 each         | 1/2" lock nut                                    |
| 9             | 517-H60P15 Rev. Mnt w/hub  | 2 each          | Sprocket H60P-15 1 1/4 Rev. Mnt with HUB P-1 1/4 |
| 10            | 517-H60P15 w/hub           | 2 each          | Sprocket, single w/hub                           |
| 11            | 517-guard, chain           | 2 each          | Chsin Guard                                      |
| 12            | 517-1/4 lockwasher         | 6 each          | 1/4" lock washers                                |
| 13            | 517-1/4 x 1/2 allen bolt   | 6 each          | 1/4 x 1/2 allen bolts                            |
| 14            | 517-HD601rg-CH w/cl        | 4 each          | Reach Chain No. 60, 25 pitches, w/connector      |
| 15            | 517-5/16 x 1-1/4 key       | 2 each          | 5/16" x 1-3/4" key                               |
| 16            | 517 DS60BS-spec            | 2 each          | Sprocket, Double Motor (not rebored)             |
| 17            | 517-EAT 104-motor          | 2 each          | Motor - Eaton H.D. 104-1420-006                  |
| 18            | 517-5.25-pwr roller        | 4 each          | Power rollers - Rauch Mfg. No. 20                |
| 19            | 517-1/4 x 1-1/4 key        | 4 each          | 1/4" x 1-1/4" Key                                |
| 20            | 517-A-602-CA               | 4 each*         | 36 SCBN -36 Service Chamber                      |
| 21            | 517-3/8 hose conn. Elbow   | 4 each*         | 3/8" hose connector elbow                        |
| 22            | 517-3/8 hose conn. Fitting | 4 each*         | 3/8" hose connector fitting                      |

| <u>ITEM #</u> | <u>ORDER#</u>               | <u>QUANTITY</u> | <u>DESCRIPTION</u>                                      |
|---------------|-----------------------------|-----------------|---|
| 23            | 517-air pot bracket         | 8 each*         | Air Pot brackets  |
| 24            | 517-1/4 lockwasher          | 3 each          | 1/4" lock washers                                       |
| 25            | 517-1/4 x 1/2 allen bolt    | 3 each          | 1/4" x 1/2" allen bolts                                 |
| 26            | 517-guage 3000 psi          | 2 each          | Gauge 3000 LN3M-25                                      |
| 27            | 517-reducer to guage        | 2 each          | 5405 Reducer (to Gauge) M pipe x F pipe                 |
| 28            | 517-guage 160 psi           | 1 each          | Air Gauge 160 psi                                       |
| 29            | 517-5602 adapter            | 3 each          | 5602 Adapter M pipe x F pipe x F pipe                   |
| 30            | 517-hanger                  | 1 each          | Hanger Arm  |
| 31            | 517-2501 adapter            | 1 each          | 2501 Adapter  |
| 32            | 517-rex roth valve          | 1 each          | Rex Roth Valve  |
| 33            | 517-5/16 x 3/4 bolt         | 2 each          | 5/16" x 3/4" allen bolt                                 |
| 34            | 517-5/16 lockwasher         | 2 each          | 5/16" lockwasher  |
| 35            | 517-1 x 4 1/2 tear drop pin | 2 each          | 1" x 4 1/2" tear drop pin w/zerk                        |
| 36            | 517-1/8 grease zerk         | 2 each          | 1/8" grease zerk  |
| 37            | 517-arrow R352 air reg.     | 1 each          | Arrow R352 Air Regulator 1/4" aop                       |
| 38            | 517-cross valve             | 1 each          | Single-Cross-Valve                                      |
| 39            | 517-2501 adapter-Valve      | 1 each          | 2501 Adapter into Valve                                 |
| 40            | 517-Hyd Mtr Hose-(#2/512H)  | 4 each          | Hyd. Mtr Hose#5 100R2HA08(08F.JICX08F.J90T) 37- 1/4"OAL |
| 41            | 517-Overload Protector      | 2 each          | Overload Protector                                      |

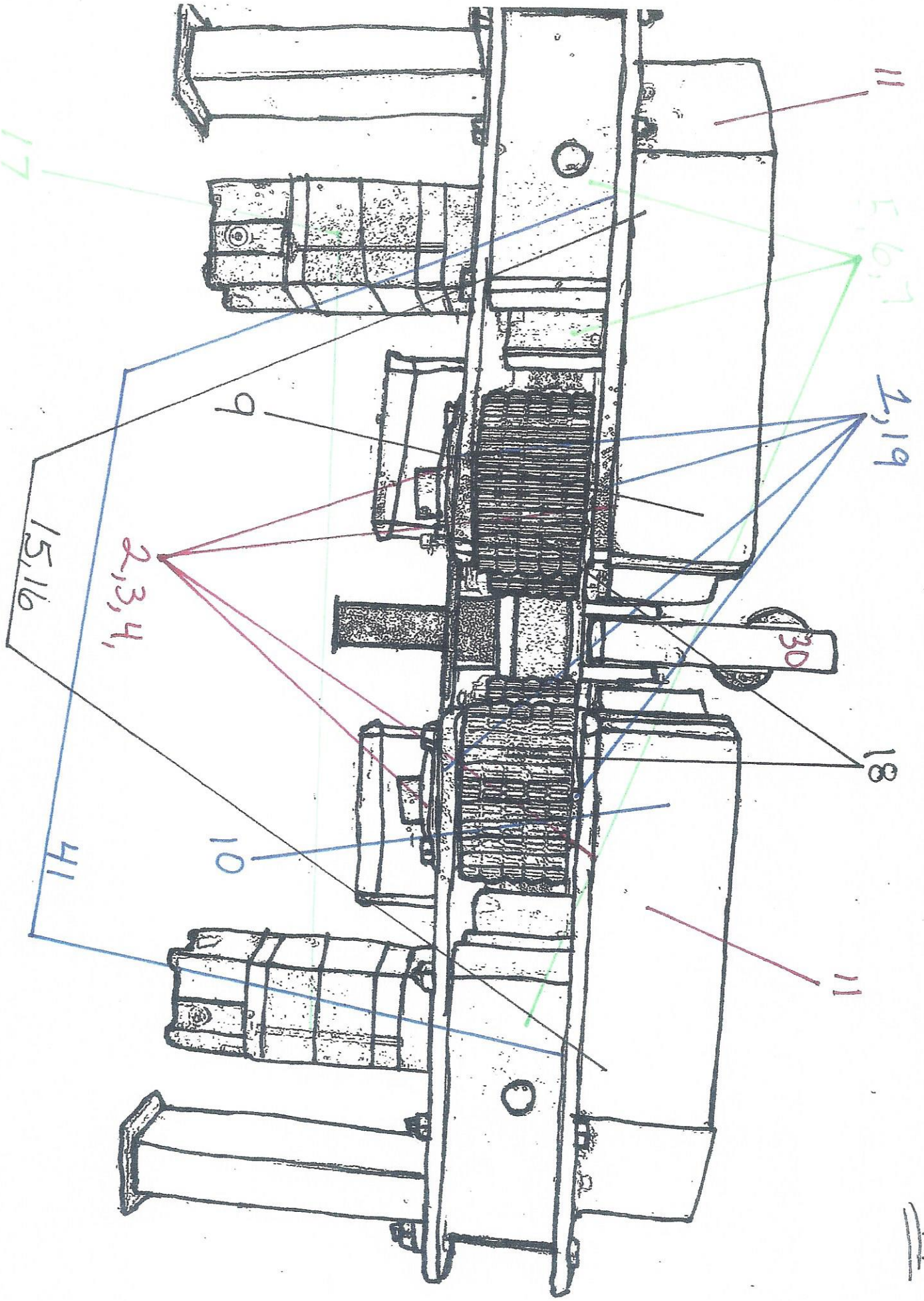

517

517

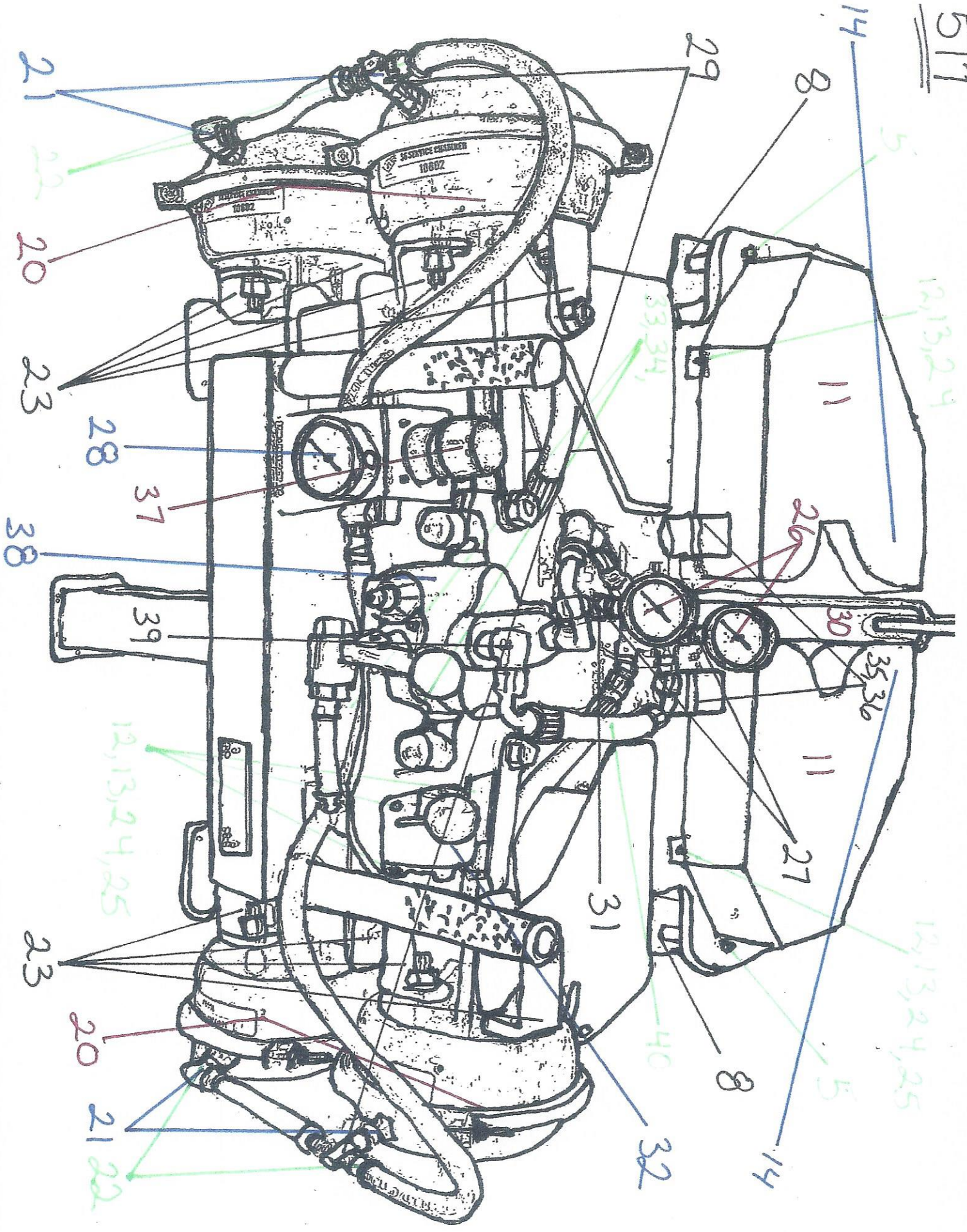

## SAFETY PRECAUTIONS FOR THE RAUCH SPINNER

### **WARNING: FAILURE TO FOLLOW THESE RULES MAY RESULT IN SERIOUS PERSONAL INJURY.**

As with all machinery there are certain hazards involved with the operation and use of the Rauch Spinner. Using the Spinner with caution and respect will considerably lessen the possibility of personal injury.

However, if normal safety precautions are overlooked or ignored, personal injury to the operator and bystanders may result.

This machine was designed for certain applications only. Rauch Manufacturing, Inc. strongly recommends that this machine NOT be modified and/or used for any application other than for which it was designed. If you have any questions relative to its application DO NOT use the machine until you have written or called Rauch Manufacturing, Inc. and we have advised you.

Rauch Manufacturing, Inc.

Phone: 208-365-3492

[www.rauchmfg.com](http://www.rauchmfg.com)

2547 W. Success Way

Emmett, Idaho 83617

## **SAFETY RULES FOR THE RAUCH SPINNER**

1. **Make sure all cables and hoses are properly tightened before using the Rauch Spinner.**
2. **When putting the Spinner Tool on the pipe MAKE SURE THE TOOL IS ALL THE WAY ON THE DRILL PIPE before actuating the air valve.**
3. **Be sure you DON'T GO OVER 3000 psi ON THE MOTOR OR 23 GALLONS PER MINUTE.**
4. **Be sure you DON'T GO OVER 150 psi ON THE AIR CYLINDER.**
5. **HAVE HYDRAULICS TURNED OFF BEFORE DISCONNECTING.**
6. **DO NOT operate while under the influence of drugs, alcohol, or medication.**
7. **STAY ALERT.** Watch what you are doing. Use common sense. Do not operate tool when you are tired.
8. **KEEP WORK AREA CLEAN.** Cluttered and slick areas invite accidents.

9. **KNOW YOUR SPINNING TOOL.** Learn its applications and limitations as well as potential hazards related to this tool.
10. **WARNING:** The use of any other accessories not specifically related to this tool may create a hazard.
11. **DON'T FORCE THE TOOL.** It will do the job better and safer at the rate for which it was designed.
12. **USE THE RIGHT TOOL.** Don't force the small tool or attachment to do the job of a heavy duty tool. Don't use the tool for a purpose it was not intended for.
13. **DO NOT ALTER OR MISUSE TOOL.** These tools are precision built. Any alteration or modification not specified is misuse and may result in a dangerous condition.
14. **MAINTAIN TOOL WITH CARE.** Keep tool clean for better and safer performance.
15. **TURN OFF** the machine if the tool is to be backed out of an uncompleted or jammed operation.
16. **Keep guards in place and in working order.**
17. **WARNING: KEEP HANDS, FEET, HAIR AND LOOSE CLOTHING AND JEWELRY AWAY FROM ANY MOVING PARTS ON THE RAUCH SPINNER AND RELATED EQUIPMENT AND PARTS.**
18. **Never leave tool running unattended. Turn off. Don't leave tool until it comes to a complete stop.**
19. **Disconnect machine from power source when making repairs.**
20. **TO AVOID BACK INJURY,** get help when lifting the tool. Hold the tool close to your body. Bend your knees so you can lift with your legs, not your back.
21. **NEVER STAND ON THE TOOL.** Serious injury could occur. Do not store anything above or near the tool where anyone might stand on the tool to reach them.
22. **BEFORE EACH USE:**
  - inspect alignment of moving parts
  - inspect binding of moving parts.
  - check for broken or damaged parts.
  - make sure all washers, nuts, cable connections and hose connections are tight.
  - make sure no parts have excessive play.
  - if any part is missing, bent, or broken in any way, or not working properly, **TURN TOOL OFF** . Replace damaged, missing, or failed parts before using the tool again.

23. **KEEP CHILDREN AND VISITORS AWAY.** Do not let visitors or children contact the tool. All visitors and children should wear safety glasses and be kept a safe distance from work area. Store idle tool out of reach of children.
24. **PLAN AHEAD TO PROTECT YOUR EYES, HANDS, FACE, EARS:**
- Plan your work. Think through how you will hold and maneuver the workpiece. Plan the way You will hold the workpiece from start to finish. Avoid awkward operations and hand positions where a sudden slip could cause injury. **ALWAYS HAVE BOTH HANDS ON THE SPINNING TOOL.**
  - **WARNING: BE AWARE THAT KICKBACKS AND THROWBACKS CAN OCCUR AT ANY TIME.** It is important to support the work properly and to hold the tool firmly to prevent loss of control which could cause personal injury.
  - Don't overreach. Keep good footing and balance. Keep your face and body to one side, out of line with a possible throwback.
25. **DRESS FOR SAFETY:**
- **Wear safety goggles.** Any power tool can throw foreign objects into the eyes. This can cause permanent eye damage. Wear approved safety glasses or safety goggles when operating the tool.
  - **Wear ear plugs.** Noise levels vary widely. To avoid possible hearing damage, wear ear plugs or muffs when using the spinning tool for extended periods of time.
  - **Wear nonslip footwear.**
  - **Tie back long hair.**
  - **Remove tie, rings, watch and other jewelry and roll up sleeves.**



## Operation

1. Be sure the spring canister is mounted on the cable that the Rauch Spinner is hanging from in order to allow the tool to move up and down with ease.
2. Make sure all cables and hoses are properly tightened before using the Rauch Spinner.
3. Make sure hydraulic return and feed hoses are the same size.
4. Make sure hydraulic oil is filtered going into the tool to prevent damage to the hydraulic motor.
5. When putting the Spinner Tool on the pipe make sure the tool is all the way on the drill pipe before actuating the air valve.
6. Recommended hydraulic flow is 16-20 gpm or 2500 psi. Do not exceed 3000 psi on the motor or 23 gallons per minute.
7. Recommended Air pressure is 120 to 140 psi with desirable pressure at 140-150 psi. Do not go over 150 psi on the Air Cylinder.
8. Have hydraulics turned off before disconnecting.
9. Don't force the tool. It will do the job better and safer at the rate for which it was designed.
10. Turn off the machine if the tool is to be backed out of an uncompleted or jammed operation.
11. Never leave tool running unattended. Turn off. Don't leave tool until it comes to a complete stop.
12. Disconnect machine from power source when making repairs
13. Before each use:
  - inspect alignment of moving parts
  - inspect binding of moving parts
  - check for broken or damaged parts
  - make sure all washers, nuts, cable connections and hose connections are tight.
  - make sure no parts have excessive play.
  - if any part is missing, bent, or broken in any way, or not working properly, TURN TOOL OFF. Replace damaged, missing, or failed parts before using the tool again.

### **ADJUSTING TOOL FOR DIFFERENT PIPE SIZES**

1) During the adjustment, remove the 1/2" bolt on the clevis. Twist the clevis in or out to adjust the power arm for larger or smaller pipe. Replace the 1/2" bolt on the clevis and tighten it.

NOTE: For proper adjustment, there should be 3/8" to 1/4" distance between the Spinner's smooth roller and the pipe.

2) For larger diameter pipe, remove the 1/2" bolt on the clevis and swing the power arm out and place the clevis/bolt in the outside hole on the power arm. Be sure and adjust the clevis for the right diameter pipe.

3) Grease zerk on power arm twice a day.

### **Hydraulic Spinning Tools Pressure Regulator**

- Hydraulic Ram lever is on the right.
- For Galvanized pipe, decrease pressure.
- For larger diameter and thicker pipe, increase pressure.
- Adjustments should be made for each application of pipe.

## Maintenance

~Each tool has 4 grease zerks [A, B, C, D] If you have the double power arm model there is a 5<sup>th</sup> zerk [E].

“A” is located on the power arm side of the hydraulic ram

“B” is located on top of the power arm shaft;

“C” is located on top of the smooth roller shaft;

“D” is located on the backside (between the plates and the traction rollers).

“E” is located, on double power arm models only,  
on the bottom side of the smooth roller pin

**\*\*\*BE SURE AND KEEP THE ZERKS GREASED\*\*\***

~Inspect hydraulic lines frequently.

~DO NOT EXCEED 1800psi HYDRAULIC PRESSURE.

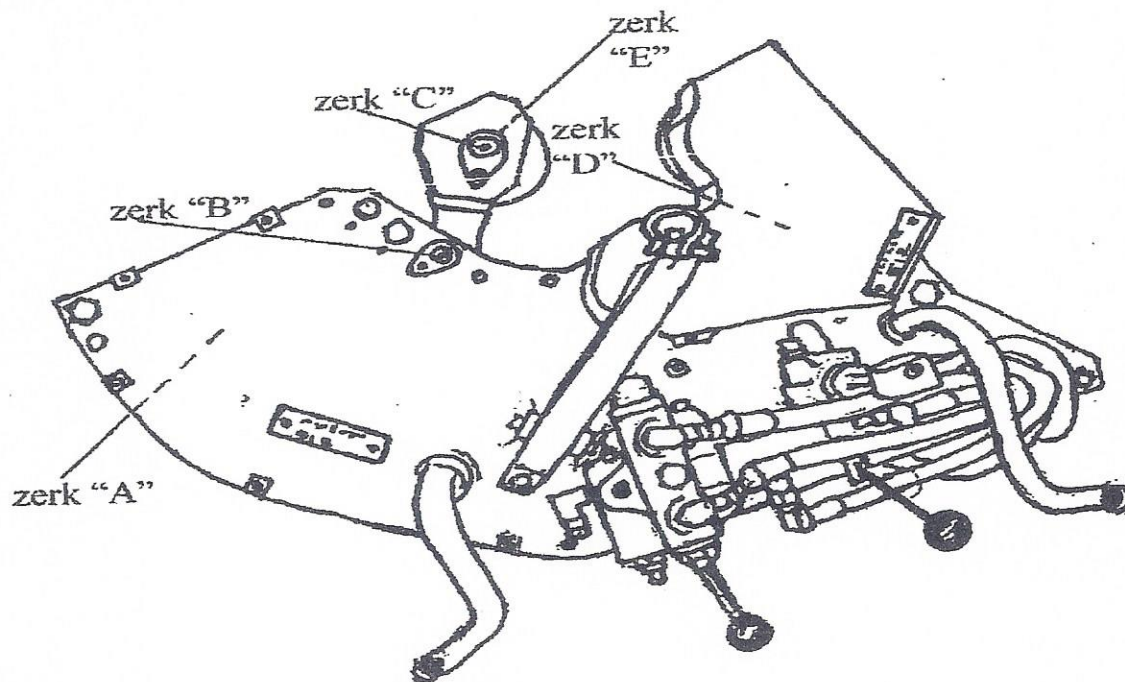

## Spring Canister

The spring canister can mount on the right side of the rig on Gardner Denver Equipment. The canister goes up 12-13 feet on the mount as indicated in the drawing. Adjust the cables to set the elevation of the tool so it is the right height to spin the pipe.

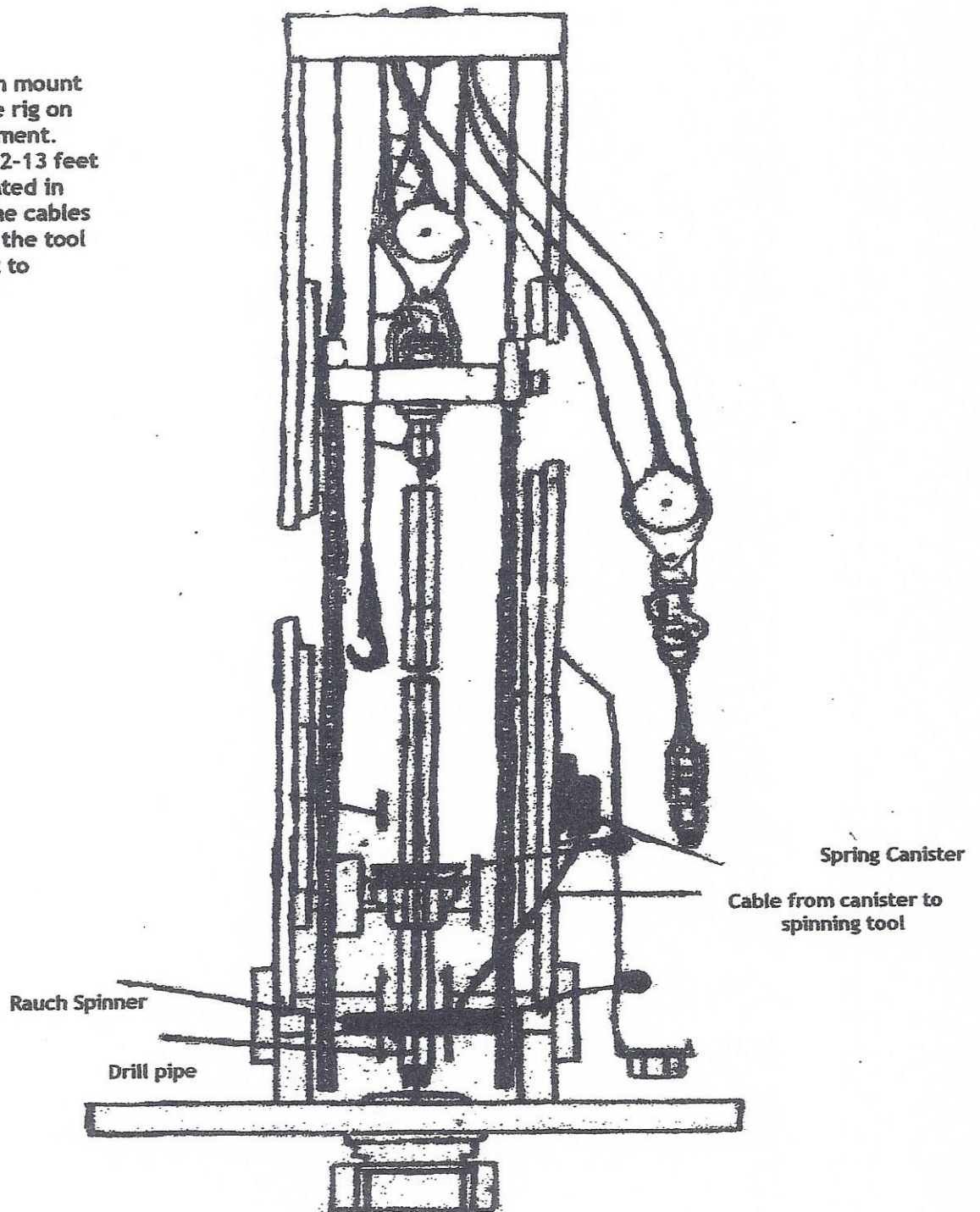

## Ordering Information

- Please have the model of your spinning tool when you call to order parts or replacement tools
- Please refer to the parts list enclosed
- For your convenience you can email orders to  
RauchMfg@outlook.com
- You may fax orders to us at 208-365-3792
- You may call us at 208-365-3492
- Rauch is always glad to help with any problems/issues you may have regarding your spinner and its use.